



SECRETS OF THE DOURO

March 25-April 3, 2027

TOUR HIGHLIGHTS

- 7-Night Cruise Aboard Emerald Radiance
- Porto, Portugal
- Douro Valley
- Pinhao, Portugal
- Quinta do Tedo, Portugal
- Salamanca, Spain
- Pocinho, Portugal
- Lamego, Portugal



A \$500 deposit per person is required with your registration form to reserve your spot.

Registration & deposit must be received by **May 15, 2026**.

Deposit becomes non-refundable on **June 15, 2026**.

**FINAL PAYMENT IS DUE:
NOVEMBER 10, 2026**

To register online, visit:

<https://stardestinations.mytravelerprofile.com/booking?DC=27044:20270325>

TOUR PRICING*

(Double Occupancy)

Trip Costs Per Person

(1 available)	Cat. F Stateroom (153 sqft)**	\$6,255 Double
(2 available)	Cat. E Stateroom (170 sqft)**	\$6,465 Double
(10 available)	Cat. C Panorama Balcony (160 sqft)**	\$6,799 Double

Optional Insurance available.

*A credit card convenience fee of 3% will be applied to all transactions. This fee is charged to cover the processing costs associated with credit card payments. Please note that this fee is non-refundable if a credit card refund is processed.

*Single pricing available upon request.

*No transaction fee if paid by check or ACH.

**Staterooms subject to availability at time of registration.

DAILY ITINERARY



Porto



Douro Valley



Quinta do Têdo



Salamanca

DAY 1 THURSDAY, MARCH 25

OVERNIGHT FLIGHT

Our journey begins with an overnight flight bound for enchanting **Porto, Portugal**.

DAY 2 FRIDAY, MARCH 26

PORTO

Arrive in vibrant **Porto**, where terraced hillsides tumble toward the shimmering Douro River, offering a postcard-perfect welcome. After checking into our hotel and settling in, enjoy a relaxing evening at your leisure. With dinner on your own and time to explore, you may choose to wander the city's charming cobblestone streets, savor local Portuguese flavors, or simply soak in the lively, welcoming atmosphere of this captivating coastal gem.

DAY 3 SATURDAY, MARCH 27

PORTO

(B, D)

This morning, **step aboard the elegant Emerald Radiance** for an intimate and refined way to experience the Douro River. Specially designed for this picturesque waterway, the ship offers stylish staterooms, inviting lounges, and a spacious Sun Deck—perfect for soaking in sweeping views of the vine-covered valley. Throughout our journey, savor locally inspired cuisine, unwind by the serene pool area, and enjoy attentive, personalized service. With its warm ambiance and thoughtfully curated amenities, Emerald Radiance delivers a relaxed, boutique-style cruising experience from beginning to end.

DAY 4 SUNDAY, MARCH 28

PINHÃO

(B, L, D)

Relax on board today as we drift through the breathtaking UNESCO World Heritage-listed **Douro Valley**, where nearly 2,000 years of winemaking tradition have sculpted dramatic terraces into the hillsides, creating one of Europe's most enchanting landscapes. Sun-drenched vineyards cling to steep slopes, while quiet villages rest peacefully along the riverbanks, each bend revealing another postcard-worthy view. This evening, gather with our fellow travelers for a warm welcome dinner and festive cocktail reception—an inviting and memorable way to toast the beginning of our unforgettable Douro River journey.

EmeraldPLUS: Portuguese cooking demonstration on board

DAY 5 MONDAY, MARCH 29

VEGA DE TERRÓN

(B, L, D)

Start the day with a visit to the enchanting **Quinta do Têdo**, an 18th-century wine estate nestled at the confluence of the Douro and Têdo Rivers. Framed by sweeping terraces and sun-kissed vineyards, this boutique quinta embraces environmentally friendly practices and crafts exceptional organic wines using time-honored techniques. A **guided tour and tasting** invite us to savor the distinctive flavors that define the Douro Valley. This afternoon, return to the comfort of our ship and cruise toward **Vega de Terrón**, unwinding on the Sun Deck as terraced hillsides glide past in the warm, golden Portuguese light.

EmeraldACTIVE: Kayak experience in Pinhão

EmeraldACTIVE: Guided active walk through the vineyards

DAY 6 TUESDAY, MARCH 30

SALAMANCA

(B, L, D)

Steeped in centuries of scholarship and culture, **Salamanca** unfolds as one of Spain's most captivating historic cities. A **guided walk** through its UNESCO-listed Old Quarter reveals sunlit sandstone façades that have earned it the nickname "Golden City," along with layers of influence shaped by ancient civilizations and medieval grandeur. Wander across the grand Plaza Mayor, alive with elegant arcades and local energy, pause at the shell-studded Casa de las Conchas, and explore the renowned University of Salamanca, a beacon of learning since the early 13th century.

EmeraldPLUS: Tuna music band in Salamanca

DAY 7 WEDNESDAY, MARCH 31 **RÉGUA** **(B, L, D)**

Step ashore in **Pocinho** this morning for a journey to **Castelo Rodrigo**, a hilltop medieval village where history unfolds within ancient stone walls and sweeping countryside views. Stroll through timeworn streets, discover remnants of its storied past, and enjoy the opportunity to taste regional specialties that reflect the heart of rural Portugal. Back on board, enjoy a relaxed lunch before spending the afternoon at ease, taking in ever-changing valley scenery from the comfort of the ship while a spirited Port wine cocktail lesson (not included) adds a touch of fun as we cruise toward **Régua**.

EmeraldPLUS: Port wine cocktail lesson on board

DiscoverMORE: Archaeological tour by 4x4 at the Côa Valley Museum (extra expense)

DAY 8 THURSDAY, APRIL 1 **RÉGUA** **(B, L, D)**

Today's included excursion showcases the charm and character of **Lamego**, a standout town in the heart of the Douro region. Visit the striking Shrine of Our Lady of Remedies, crowned by an impressive stairway layered with decorative tiles, fountains, and sweeping viewpoints—those who wish may take the rewarding walk down its famed steps. The experience continues at Quinta da Pacheca, a storied wine estate set amid rolling vineyards, where a relaxed rural lunch is paired with acclaimed local wines.

EmeraldPLUS: Rural lunch at Quinta da Pacheca

EmeraldPLUS: Mosaic tile painting lesson on board

EmeraldACTIVE: Walk down the steps of the Sanctuary of Our Lady of Remedies

DiscoverMORE: Visit to Mateus Manor House (extra expense)

DAY 9 FRIDAY, APRIL 2 **PORTO** **(B, L, D)**

Set where the Douro meets the Atlantic, **Porto** reveals a dynamic mix of heritage and modern energy, shaped by centuries of maritime trade and a deep-rooted wine legacy. Our included excursion highlights Porto's coastal character with visits to the commanding Castelo da Foz and the uniquely shaped Castelo do Queijo, both offering dramatic ocean views. Alternatively, choose an engaging walking tour through the city's lively neighborhoods, where colorful tilework, bustling markets, and authentic daily life capture the unmistakable spirit of Porto.

EmeraldPLUS: A cruise through Porto

EmeraldACTIVE: Guided active walk in Porto

DiscoverMORE: Visit Quinta da Aveleda (extra expense)

DiscoverMORE: Guided bike tour to the Atlantic (extra expense)

DAY 10 SATURDAY, APRIL 3 **HOME** **(B)**

This morning, say goodbye to our Star-Ship and transfer to the airport for your journey home.



Castelo Rodrigo



Shrine of Our Lady of Remedies



Vineyards Along Douro River



Castelo do Queijo

INCLUSIONS

- Round-Trip Air to Porto
- Motorcoach Transportation to Hotel/Pier/Airport
- 1 Night's Accommodations
- 1 Meal on Land & All Onboard Meals
- 7-Night Cruise in Cabin Category of Choice
- Porter Service of One Bag Per Person at Hotels
- Taxes & Gratuities for Included Services on Land & Cruise
- Star Destinations Tour Manager
- Complimentary Beer, Wine, and Soft Drinks with Lunch & Dinner on Cruise
- 5 Shore Excursions

WHERE TO?



Activity Level 2: Minimal to Moderate

2-3 hours of easy-paced walking at a time; some stairs and uneven surfaces due to nature of attractions.

For further information or questions, please contact:

Star Destinations

(712) 792-9793

kasey@stardestinations.com

OPTIONAL TRAVEL PROTECTION

Star Destinations RECOMMENDS that all travelers purchase a Travel Protection Plan. For your convenience, we offer a Travel Protection Plan provided by Travelex Insurance Services.

See the included Travelex Insurance Services flyer for pricing.

Travel Protection Plan may be purchased any time before or with final payment to Star Destinations.

Travelex Insurance Services Inc. CA Agency License #0D10209 ("Travelex Insurance") maintains an updated list of alerts, restricted destinations, and financial defaults on its website available at <https://www.travelexinsurance.com/customer-service/travel-alerts/travel-supplier>.

Insurance coverages underwritten by Zurich American Insurance Company (NAIC #16535, state of domicile: New York), 1299 Zurich Way, Schaumburg, IL 60196.

DOCUMENTATION: Each U.S. citizen must have a valid passport through October 3, 2027, to participate. If you don't have a passport, call our office and we'll tell you how to apply for one. Holders of non-U.S. passports have different entry requirements. Please NOTE: Due to airline security measures, your passport name must match your airline ticket name and your tour reservation name or you may be denied aircraft boarding. All travelers to United Kingdom must apply for an Electronic Travel Authorization (ETA) prior to departure, effective 2025. All travelers to the Schengen zone of Europe will be processed through the new Entry/Exit System (EES). In addition, beginning in 2026 (expected), travelers will need to apply for an ETIAS for entry into Schengen countries.

OPTIONAL TRAVEL PROTECTION PLAN: Star Destinations recommends that you purchase a Travel Protection Plan to help protect you and your travel investment against the unexpected so you can relax and enjoy your trip. Participants may purchase this coverage from the provider of your choice. For your convenience, we offer a Travel Protection Plan, provided by Travelex Insurance Services, that helps provide coverage for trip cancellation/interruption, trip delay, baggage loss, theft or damage, medical expense and emergency evacuation coverage, and more. For more information, please see the included product flyer. If you would like to purchase the offered plan, please check the applicable box on the registration form. Please Note: The plan must be purchased at or before final payment in order to be eligible for a waiver or pre-existing medical conditions. If the reason for cancellation is due to a medical or other eligible reason, you may be eligible for reimbursement for such fees from your Travel Protection Plan provider. To view/download the Policy, which provides the full coverage terms and details, including limitations and exclusions, go to: <https://policy.travelexinsurance.com/385ZA-1224>. To view state specific fraud warnings, visit: <https://www.travelexinsurance.com/company/fraud-warning>. The purchase of this product is not required in order to purchase any other travel product or service. Your travel retailer might not be licensed to sell travel insurance and will only be able to provide general information about the product. An unlicensed travel retailer may not answer questions about the terms and conditions of the insurance offered and may not evaluate the adequacy of your existing insurance coverage. The products being offered provide insurance coverage that only applies during your covered trip. You may have insurance coverage from other sources that provide similar benefits but may be subject to different restrictions depending upon the coverage. You may wish to compare the terms of the travel policy offered through Travelex with any existing life, health, home, and automobile insurance policies you may have. If you have questions about your coverage under your existing insurance policies, contact your insurer or insurance agent or broker. Travelex Insurance Services, Inc. CA Agency License #0D10209. Travel Insurance is offered on behalf of and under the direction of Travelex Insurance Services. Insurance coverages underwritten by Zurich American Insurance Company (NAIC #16535, state of domicile: New York), 1299 Zurich Way, Schaumburg, IL 60196.

CANCELLATION: Full refund of all monies is made if cancellation is received in writing to Star Destinations prior to final payment, less the non-refundable \$500 and the 3% credit card transaction fee (if a credit card is used). A 100% fee is charged if the cancellation occurs between final payment and departure.

TRAVELERS WITH SPECIAL NEEDS: You must advise Star Destinations, Inc. (SDI) at the time of registration of any disability requiring special attention. SDI will make reasonable efforts to accommodate the special needs of travelers. The Americans with Disabilities Act is applicable only in the U.S., and accommodations outside the U.S. may be more limited. Travelers requiring assistance are required to be accompanied by a companion who is capable of, and totally responsible for, providing the assistance. Neither SDI personnel nor its suppliers may lift or physically assist with travelers' special needs including, but not limited to, walking, dining, or other routine activities. Travelers thinking they may need assistance should call SDI to determine what accommodations may reasonably be provided. Arrangements at an additional cost are the financial responsibility of the traveler.

TERMS AND CONDITIONS: Star Destinations, Inc. (SDI) acts as an agent for suppliers such as airlines, hotels, or activities to provide you with the travel services and accommodations. Although great care is taken in choosing suppliers we are unable to control them and therefore, cannot be held responsible or liable for their acts or omissions. Should a contracted supplier be unable to perform the required services, SDI reserves the right to substitute advertised services with similar services. SDI is not responsible for any claims, losses, damages, costs, or expenses arising out of injury, accident or death, damage, loss, trip delay, delay of baggage, cancellation, or other inconvenience resulting from mechanical breakdowns, fire, theft, civil disturbances, health concerns, government actions, weather, and other factors beyond our control. In the case of a pandemic or worldwide or localized disturbance that interrupts or cancels your planned tour, SDI will do everything possible to retrieve any refundable components of your tour but cannot be held responsible for any non-refundable portions of the tour. In addition, SDI reserves the right to vary the tour price advertised or printed to cover any increase in airfare, volatile fuel prices, government taxes and charges, exchange rate fluctuations, or other tour-related tariffs or newly announced travel costs. The price of this tour is based on the EUR/USD exchange rate of \$1.15 as of 11/20/25. The price of this tour is based on the US Dollar exchange rate at the time of the creation of the tour. Pricing and restrictions may be increased due to unexpected requirements for health, safety, or economic welfare of tour members. Be aware that any public interaction carries an inherent risk of exposure to infectious disease or illness and travelers assume personal risk upon tour registration. If you request a variation or change to your booking, SDI may choose to accept or reject that request. If accepted, you are responsible for any fees associated with it. If the minimum number of passengers required to operate the tour is not met, SDI reserves the right to cancel the tour.

It is the sole discretion of SDI to refuse transport to any passenger, or require any passenger to leave the tour, if it is reasonably believed that the passenger (1) is dangerous to others or himself or herself; (2) is engaged in or is threatening to engage in behavior that may adversely affect the safety, security, enjoyment, or well-being of other passengers, including behavior that is disruptive, verbally or physically abusive, obnoxious, harassing, or obscene; or (3) has failed or refused to follow SDI's rules and procedures or the instructions of its representatives. In the event a passenger is removed, such passenger may be left at any location without any liability to SDI or its representatives. SDI shall not be required to refund any portion of the price paid by any passenger who is removed, nor shall SDI be responsible for any further expenses incurred by the passenger. SDI shall be entitled to recover from the passenger any costs or expenses incurred by SDI or its representatives in the removal of the passenger or the exercise or enforcement of this clause.

TRAVEL INSURANCE IS HIGHLY ENCOURAGED ON ALL SDI TOURS. REFUSAL OF TRAVEL INSURANCE IS DONE AGAINST THE ADVICE OF SDI AND IT'S TOUR PROFESSIONALS.



LISBON POST-TOUR

April 3-6, 2027

TOUR PRICING*

\$1,150 per person, double occupancy

\$1,705 per person, single occupancy

Optional Insurance available.

*A credit card convenience fee of 3% will be applied to all transactions. This fee is charged to cover the processing costs associated with credit card payments. Please note that this fee is non-refundable if a credit card refund is processed.

*No transaction fee if paid by check or ACH.

A \$100 deposit per person is required with your registration form in order to reserve your spot.

**FINAL PAYMENT IS DUE:
NOVEMBER 10, 2026**

To register online, visit:

<https://stardestinations.mytravelerprofile.com/booking?DC=27044:20270325>

For further information or questions, please contact:

**Star Destinations
(712) 792-9793**

kasey@stardestinations.com

INCLUSIONS

- Round-Trip Air to Porto & Return From Lisbon
- Motorcoach Transportation to Hotel/Pier/Airport
- 3 Nights' Accommodations
- 3 Meals (3 Breakfasts)
- Guided City Tour of Lisbon
- Taxes & Gratuities for Included Services
- Porter Service of One Bag Per Person at Hotel When Available

Activity Level 2: Minimal to Moderate

2-3 hours of easy-paced walking at a time; some stairs and uneven surfaces due to nature of attractions.

OPTIONAL TRAVEL PROTECTION

Star Destinations **RECOMMENDS** that all travelers purchase a Travel Protection Plan. For your convenience, we offer a Travel Protection Plan provided by Traveler Insurance Services.

See the included Traveler Insurance Services flyer for pricing.

Travel Protection Plan may be purchased any time before or with final payment to Star Destinations.

Traveler Insurance Services Inc. CA Agency License #0D10209 ("Traveler Insurance") maintains an updated list of alerts, restricted destinations, and financial defaults on its website available at <https://www.travelerinsurance.com/customer-service/travel-alerts/travel-supplier>.

Insurance coverages underwritten by Zurich American Insurance Company (NAIC #16535, state of domicile: New York), 1299 Zurich Way, Schaumburg, IL 60196.

DAILY ITINERARY

DAY 1 SATURDAY, APRIL 3

LISBON

Journey onward to the storybook village of **Óbidos**, a perfectly preserved medieval treasure wrapped in centuries-old stone walls. Wander its narrow, cobblestone streets where whitewashed homes spill over with colorful flowers and charming artisan shops, creating an atmosphere straight out of a fairytale. From there, arrive in **Lisbon**—Portugal’s luminous capital—where golden light dances across tiled façades, historic neighborhoods rise and fall over sunlit hills, and echoes of a proud maritime past linger at every turn. Our three-night stay offers ample time to soak in Lisbon’s vibrant energy, timeless beauty, and unmistakable charm that has enchanted travelers for generations.



DAY 2 SUNDAY, APRIL 4

LISBON

(B)

Today, dive into the energy of Lisbon on a **guided tour** through its bustling city center, where grand plazas, charming cafés, and elegant boulevards invite exploration at every turn. Watch the city’s iconic yellow trams clatter past colorful façades and historic streets, capturing the unmistakable rhythm and warmth of Portugal’s capital. The journey continues to the legendary waterfront district of **Belém**, a focal point of the Age of Discovery, where we’ll encounter the awe-inspiring **Jerónimos Monastery**. With its soaring arches, ornate stonework, and exquisite Manueline design, this UNESCO World Heritage Site stands as a powerful tribute to Portugal’s seafaring legacy and one of Lisbon’s most breathtaking and beloved landmarks.



DAY 3 MONDAY, APRIL 5

LISBON

(B)

Set out and experience Lisbon exactly as you please, letting the city reveal itself one moment at a time. Follow winding streets into vibrant neighborhoods where ornate churches, softly painted buildings, and elevated viewpoints reward you with sweeping riverfront panoramas. Pause to browse handcrafted treasures, settle into a café for a leisurely bite, or step inside a museum that brings Portugal’s stories to life. With expert guidance always within reach, you’re free to embrace a day of unhurried discovery in one of Europe’s most captivating capitals.



DAY 4 TUESDAY, APRIL 6

HOME

(B)

After breakfast, we will transfer to the airport.

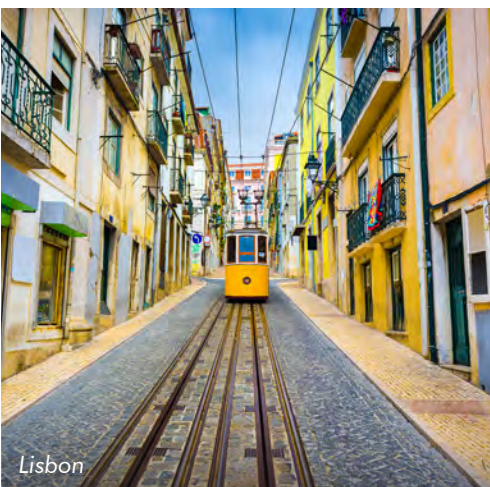

WHERE TO?



SECRETS OF THE DOURO



To register online, visit:

<https://stardestinations.mytravelerprofile.com/booking?DC=27044:20270325>

For further information or questions, please contact:
Star Destinations (712) 792-9793
kasey@stardestinations.com

March 25-April 3, 2027 (with post-tour: March 25-April 6, 2027)

PASSENGER INFORMATION (1st Traveler)

Full name must be exactly as it appears on your passport or passport application.
 Passport information may be sent later if you have yet to obtain a passport.

First Name: _____

Middle Name(s): _____

Last Name(s): _____

Preferred Name: _____ Gender (circle one): M F

Address: _____

City: _____ State: _____ Zip: _____

Preferred Phone: _____

Email: _____

Passport #: _____

Passport Expiration Date: ____/____/____
month / day / year

Date of Birth: ____/____/____
month / day / year

Dietary Needs: _____

Additional Special Requests/Needs: _____

Emergency Contact: _____

Relationship: _____

Emergency Contact's Phone: _____

Star Destinations RECOMMENDS all travelers purchase a Travel Protection Plan. For your convenience, we offer a Travel Protection Plan provided by Travellex Insurance Services.

- Yes, I would like to purchase the offered plan.**
 See the included Travellex Insurance Services flyer for pricing.
 (Payment may be sent with your deposit or with final payment to Star Destinations)
- No, I decline the offered plan.**

Any person who knowingly presents a false or fraudulent claim for payment of a loss or benefit or knowingly presents false information in an application for insurance is guilty of a crime and may be subject to fines and confinement in prison. To view state specific fraud warnings, visit:
<https://www.travellexinsurance.com/company/fraud-warning>. Travellex Insurance Services Inc. ("Travellex Insurance") maintains an updated list of alerts, restricted destinations, and financial defaults on its website available at <https://www.travellexinsurance.com/customer-service/travel-alerts/travel-supplier>.

Insurance coverages underwritten by Zurich American Insurance Company (NAIC #16535, state of domicile: New York), 1299 Zurich Way, Schaumburg, IL 60196.

Solo Travelers: Would you like to be paired with another solo traveler in a double occupancy room, if possible? Yes No

Will you be joining the Lisbon post-tour? Yes No

PASSENGER INFORMATION (2nd Traveler)

Full name must be exactly as it appears on your passport or passport application.
 Passport information may be sent later if you have yet to obtain a passport.

First Name: _____

Middle Name(s): _____

Last Name(s): _____

Preferred Name: _____ Gender (circle one): M F

Address: _____

City: _____ State: _____ Zip: _____

Preferred Phone: _____

Email: _____

Passport #: _____

Passport Expiration Date: ____/____/____
month / day / year

Date of Birth: ____/____/____
month / day / year

Dietary Needs: _____

Additional Special Requests/Needs: _____

Emergency Contact: _____

Relationship: _____

Emergency Contact's Phone: _____

Tour Pricing*:

(Double Occupancy)
Trip Costs Per Person

- | | |
|-----------------------------------------------------------------------------|---------------------------------------------------------|
| <input type="checkbox"/> Cat. F Stateroom (153 sqft - 1 available)** | \$6,255 Double
with post-tour: \$7,405 |
| <input type="checkbox"/> Cat. E Stateroom (170 sqft - 2 available)** | \$6,465 Double
with post-tour: \$7,615 |
| <input type="checkbox"/> Cat. C Balcony (160 sqft - 10 available)** | \$6,799 Double
with post-tour: \$7,949 |

*No transaction fee if paid by check or ACH.

*Single pricing available upon request.

**Staterooms subject to availability at time of registration.

Sleeping Preference (circle one): Two Beds One Bed

Roommate (name): _____

PLEASE TURN OVER FOR SIGNATURE

SECRETS OF THE DOURO

DOCUMENTATION: Each U.S. citizen must have a valid passport through October 3, 2027, to participate. If you don't have a passport, call our office and we'll tell you how to apply for one. Holders of non-U.S. passports have different entry requirements. Please NOTE: Due to airline security measures, your passport name must match your airline ticket name and your tour reservation name or you may be denied aircraft boarding. All travelers to United Kingdom must apply for an Electronic Travel Authorization (ETA) prior to departure, effective 2025. All travelers to the Schengen zone of Europe will be processed through the new Entry/Exit System (EES). In addition, beginning in 2026 (expected), travelers will need to apply for an ETIAS for entry into Schengen countries.

OPTIONAL TRAVEL PROTECTION PLAN: Star Destinations recommends that you purchase a Travel Protection Plan to help protect you and your travel investment against the unexpected so you can relax and enjoy your trip. Participants may purchase this coverage from the provider of your choice. For your convenience, we offer a Travel Protection Plan, provided by Travelex Insurance Services, that helps provide coverage for trip cancellation/interruption, trip delay, baggage loss, theft or damage, medical expense and emergency evacuation coverage, and more. For more information, please see the included product flyer. If you would like to purchase the offered plan, please check the applicable box on the registration form. Please Note: The plan must be purchased at or before final payment in order to be eligible for a waiver or pre-existing medical conditions. If the reason for cancellation is due to a medical or other eligible reason, you may be eligible for reimbursement for such fees from your Travel Protection Plan provider. To view/download the Policy, which provides the full coverage terms and details, including limitations and exclusions, go to: <https://policy.travelexinsurance.com/385ZA-1224>. To view state specific fraud warnings, visit: <https://www.travelexinsurance.com/company/fraud-warning>. The purchase of this product is not required in order to purchase any other travel product or service. Your travel retailer might not be licensed to sell travel insurance and will only be able to provide general information about the product. An unlicensed travel retailer may not answer questions about the terms and conditions of the insurance offered and may not evaluate the adequacy of your existing insurance coverage. The products being offered provide insurance coverage that only applies during your covered trip. You may have insurance coverage from other sources that provide similar benefits but may be subject to different restrictions depending upon the coverage. You may wish to compare the terms of the travel policy offered through Travelex with any existing life, health, home, and automobile insurance policies you may have. If you have questions about your coverage under your existing insurance policies, contact your insurer or insurance agent or broker. Travelex Insurance Services, Inc. CA Agency License #0D10209. Travel Insurance is offered on behalf of and under the direction of Travelex Insurance Services. Insurance coverages underwritten by Zurich American Insurance Company (NAIC #16535, state of domicile: New York), 1299 Zurich Way, Schaumburg, IL 60196.

CANCELLATION: Full refund of all monies is made if cancellation is received in writing to Star Destinations prior to final payment, less the non-refundable \$500 and the 3% credit card transaction fee (if a credit card is used). A 100% fee is charged if the cancellation occurs between final payment and departure.

TRAVELERS WITH SPECIAL NEEDS: You must advise Star Destinations, Inc. (SDI) at the time of registration of any disability requiring special attention. SDI will make reasonable efforts to accommodate the special needs of travelers. The Americans with Disabilities Act is applicable only in the U.S., and accommodations outside the U.S. may be more limited. Travelers requiring assistance are required to be accompanied by a companion who is capable of, and totally responsible for, providing the assistance. Neither SDI personnel nor its suppliers may lift or physically assist with travelers' special needs including, but not limited to, walking, dining, or other routine activities. Travelers thinking they may need assistance should call SDI to determine what accommodations may reasonably be provided. Arrangements at an additional cost are the financial responsibility of the traveler.

TERMS AND CONDITIONS: Star Destinations, Inc. (SDI) acts as an agent for suppliers such as airlines, hotels, or activities to provide you with the travel services and accommodations. Although great care is taken in choosing suppliers we are unable to control them and therefore, cannot be held responsible or liable for their acts or omissions. Should a contracted supplier be unable to perform the required services, SDI reserves the right to substitute advertised services with similar services. SDI is not responsible for any claims, losses, damages, costs, or expenses arising out of injury, accident or death, damage, loss, trip delay, delay of baggage, cancellation, or other inconvenience resulting from mechanical breakdowns, fire, theft, civil disturbances, health concerns, government actions, weather, and other factors beyond our control. In the case of a pandemic or worldwide or localized disturbance that interrupts or cancels your planned tour, SDI will do everything possible to retrieve any refundable components of your tour but cannot be held responsible for any non-refundable portions of the tour. In addition, SDI reserves the right to vary the tour price advertised or printed to cover any increase in airfare, volatile fuel prices, government taxes and charges, exchange rate fluctuations, or other tour-related tariffs or newly announced travel costs. The price of this tour is based on the EUR/USD exchange rate of \$1.15 as of 11/20/25. The price of this tour is based on the US Dollar exchange rate at the time of the creation of the tour. Pricing and restrictions may be increased due to unexpected requirements for health, safety, or economic welfare of tour members. Be aware that any public interaction carries an inherent risk of exposure to infectious disease or illness and travelers assume personal risk upon tour registration. If you request a variation or change to your booking, SDI may choose to accept or reject that request. If accepted, you are responsible for any fees associated with it. If the minimum number of passengers required to operate the tour is not met, SDI reserves the right to cancel the tour.

It is the sole discretion of SDI to refuse transport to any passenger, or require any passenger to leave the tour, if it is reasonably believed that the passenger (1) is dangerous to others or himself or herself; (2) is engaged in or is threatening to engage in behavior that may adversely affect the safety, security, enjoyment, or well-being of other passengers, including behavior that is disruptive, verbally or physically abusive, obnoxious, harassing, or obscene; or (3) has failed or refused to follow SDI's rules and procedures or the instructions of its representatives. In the event a passenger is removed, such passenger may be left at any location without any liability to SDI or its representatives. SDI shall not be required to refund any portion of the price paid by any passenger who is removed, nor shall SDI be responsible for any further expenses incurred by the passenger. SDI shall be entitled to recover from the passenger any costs or expenses incurred by SDI or its representatives in the removal of the passenger or the exercise or enforcement of this clause.

TRAVEL INSURANCE IS HIGHLY ENCOURAGED ON ALL SDI TOURS. REFUSAL OF TRAVEL INSURANCE IS DONE AGAINST THE ADVICE OF SDI AND IT'S TOUR PROFESSIONALS.

A \$500 deposit per person (\$600 with the post-tour) is required with your registration form in order to reserve your spot.

Registration & deposit must be received by **May 15, 2026.**

Deposit becomes non-refundable on **June 15, 2026.**

FINAL PAYMENT IS DUE: NOVEMBER 10, 2026

A copy of your passport is required with registration or as soon as possible.

DEPOSIT PAYMENT INFORMATION:

(No transaction fee if paid by check or ACH.)

Enclosed is my check, made payable to: **Star Destinations**

In the amount of: _____

Mail Check to: **Star Destinations**

PO Box 456, Carroll, IA 51401

Or call 712.792.9793 to pay by ACH bank transfer

CREDIT CARD PAYMENTS:

(A credit card convenience fee of 3% will be applied to all transactions. This fee is charged to cover the processing costs associated with credit card payments. Please note that this fee is non-refundable if a credit card refund is processed.)

Visa Mastercard In the amount of: _____

Credit Card Number: _____

Exp. Date: _____ / _____ Security Code: _____
month / year

Name as it appears on card: _____

By registering for this tour and signing below, **you acknowledge that Star Destinations reserves the right to refuse transport at any time to any passenger who does not meet the activity level requirements below.** Star Destinations will not be required to refund any portion of the price paid by any passenger who is removed in enforcement of this clause.

Activity Level 2: Minimal to Moderate

2-3 hours of easy-paced walking at a time; some stairs and uneven surfaces due to nature of attractions.

Signature (1st Traveler): _____

Date: _____

Please initial to indicate you have read/agree to the terms and conditions: _____

If applicable:

Frequent Flyer #s: _____

KTN #: _____

Global Entry #: _____

Signature (2nd Traveler): _____

Date: _____

Please initial to indicate you have read/agree to the terms and conditions: _____

If applicable:

Frequent Flyer #s: _____

KTN #: _____

Global Entry #: _____

By registering for this trip, I agree to grant to Star Destinations and its authorized representatives permission to record on photography film and/or video, pictures of my participation. I further agree that any or all of the material photographed may be used, in any form, as part of any future publications, brochure, or other printed or digital materials used to promote Star Destinations, and further that such use shall be without payment of fees, royalties, special credit or other compensation.

Douro deck plans

Emerald Radiance

• Built: 2017 • Length: 292ft (89m) • Guests: 112 • Cabins: 56 • Crew Members: 37

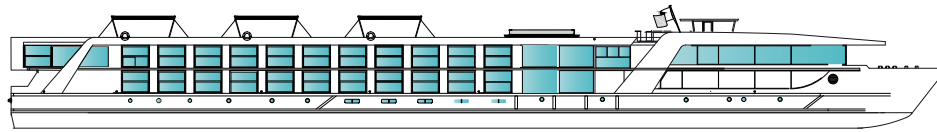

Sun Deck

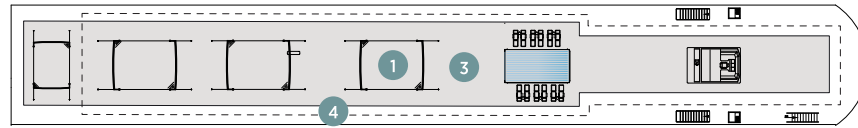

Horizon Deck

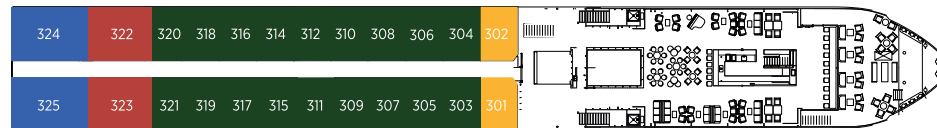

Vista Deck



Riviera Deck



Cabin Categories		
Horizon Deck		Size sq. ft. (sq. m.)
CAT RA	Emerald Riverview Suite	300 sq. ft. (27.9 sq. m.)
CAT SA	Owner's One-Bedroom Suite	285 sq. ft. (26.5 sq. m.)
CAT P	Emerald Panorama Balcony Suite	170 sq. ft. (15.8 sq. m.)
CAT A	Emerald Panorama Balcony Suite	160 sq. ft. (14.9 sq. m.)
Vista Deck		Size sq. ft. (sq. m.)
CAT R	Emerald Panorama Balcony Suite	188 sq. ft. (17.5 sq. m.)
CAT B	Emerald Panorama Balcony Suite	160 sq. ft. (14.9 sq. m.)
CAT C	Emerald Panorama Balcony Suite	160 sq. ft. (14.9 sq. m.)
Riviera Deck		Size sq. ft. (sq. m.)
CAT D	Emerald Stateroom	170 sq. ft. (15.8 sq. m.)
CAT E	Emerald Stateroom	160 sq. ft. (14.9 sq. m.)
CAT F	Emerald Stateroom	153 sq. ft. (14.3 sq. m.)

- 1 Sun Deck with Deck Chairs*
- 2 Navigation Bridge
- 3 Sky Barbecue
- 4 Walking Track
- 5 Spa-style Serenity Pool
- 6 The Terrace
- 7 Horizon Bar & Lounge
- 8 Lift
- 9 Reception
- 10 Wellness Area
- 11 Fitness Area
- 12 Reflections Restaurant

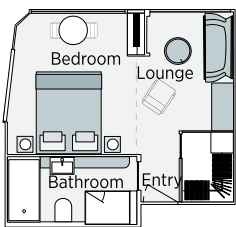

Emerald Riverview Suite
300 sq. ft. (27.9 sq. m.)

CAT RA

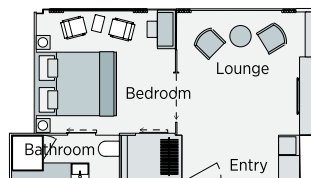

Owner's One-Bedroom Suite
285 sq. ft. (26.5 sq. m.)

CAT SA

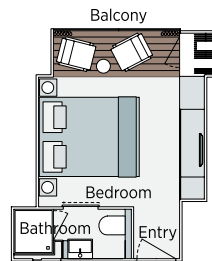

Emerald Panorama Balcony Suite
188 sq. ft. (17.5 sq. m.) - 160 sq. ft. (14.9 sq. m.)

CAT P CAT A CAT R CAT B CAT C

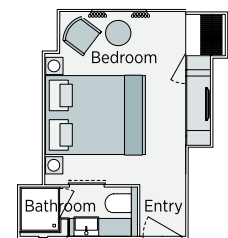

Emerald Stateroom
153 sq. ft. (14.3 sq. m.) - 170 sq. ft. (15.8 sq. m.)

CAT D CAT E CAT F

Important Information: The cabin and deck plans, sizes and photographs are an indication only and are subject to variation.
^ Due to safety, the Sun Deck will be closed when traveling under low bridges.

Star Destinations | Travel Protection

No one wants to think about what might go wrong while they're traveling. However, the world is unpredictable, so this Travelex travel protection plan helps ensure that you and your trip investments are protected if something doesn't go as planned. Adding travel protection to your trip can help you travel with confidence, so you can dream, explore, and travel on.

Star Destinations plan benefits¹

Benefits	Coverage ¹
Trip cancellation	Up to 100% of insured trip cost
Trip interruption	Up to 150% of insured trip cost
Trip interruption—return air only ²	\$750
Travel delay (6 hours)	\$750 (\$150/day)
Missed connection—air & cruise only (3 hours)	\$750
Sporting equipment delay (8 hours)	\$600
Baggage & personal effects	\$2,000
Baggage delay (12 hours)	\$250
Emergency medical expense ³ (secondary)	\$50,000
Emergency dental expense ³ (secondary)	\$500
Emergency medical evacuation & repatriation (secondary)	\$250,000
Accidental death & dismemberment	\$25,000
Exposure & disappearance	\$25,000
Travel assistance services ⁴	Included
Optional upgrades	
Cancel for any reason ⁵	Up to 75% of insured trip cost

Trip cancellation & trip interruption

Protect your travel investments and recover nonrefundable prepaid costs if your trip is canceled or interrupted for a covered reason. Popular covered reasons include:

- Sickness, injury, or death⁶
- Home uninhabitable or inaccessible
- Accommodation at destination uninhabitable or inaccessible
- Named hurricane
- Financial insolvency^{7,8}
- Theft of passport or visa
- Common carrier delay or cancellation due to severe weather, mechanical breakdown, strike or FAA mandate (12 hours)
- Delay causing 50% loss of trip due to a travel delay covered reason

Star Destinations base plan rates¹

Trip cost	Base plan cost per person	Base plan cost per person + cancel for any reason ⁵
\$1 – \$500	\$74	\$122
\$501 – \$1,000	\$96	\$158
\$1,001 – \$1,500	\$152	\$251
\$1,501 – \$2,500	\$188	\$310
\$2,501 – \$4,000	\$306	\$504
\$4,001 – \$5,500	\$447	\$737
\$5,501 – \$7,000	\$588	\$969
\$7,001 – \$8,000	\$705	\$1,163
\$8,001 – \$9,000	\$799	\$1,318
\$9,001 – \$10,000	\$893	\$1,473
\$10,001 – \$11,000	\$987	N/A
\$11,001 – \$12,000	\$1,081	N/A
\$12,001 – \$13,000	\$1,175	N/A
\$13,001 – \$14,000	\$1,269	N/A
\$14,001 – \$15,000	\$1,363	N/A
\$15,001 – \$16,000	\$1,457	N/A
\$16,001 – \$17,000	\$1,551	N/A
\$17,001 – \$18,000	\$1,645	N/A
\$18,001 – \$19,000	\$1,739	N/A
\$19,001 – \$20,000	\$1,833	N/A

¹Coverages, rates, and maximum trip length may vary by state. The maximum trip length is 90 days. Please see your policy for details, or call +1.844.808.5950. Covered expenses will only be paid after benefits have been paid under any "in force policy" in effect for the Insured. Medical and dental coverage is primary for residents of CT. ²Coverage for trip interruption and trip interruption—return air only may not be combined for residents of CT, IN, KS, MO, MT, VT, and WA. ³\$50 deductible for residents of CT, IN, KS, MO, MT, VT, and WA. ⁴Provided by the designated provider as listed in the policy. ⁵Cancel for any fortuitous reason for residents of NY. ⁶Of you, a traveling companion, family member, business partner, or host at destination. ⁷Must occur more than 14 days after effective date. ⁸Plan must be purchased within 21 days of initial trip deposit to be eligible for this covered reason. 1224-STRFLY1_SR_112524_V1



Questions about plan benefits?

Call +1.844.808.5950 or email CustomerSolutions@TravelexInsurance.com and reference Plan 385ZA-1224.

Missed connection—air & cruise only

Reimbursement for reasonable additional lodging, meal expenses, and the prepaid unused nonrefundable portion of the trip if a connection is missed by three hours or more for a covered reason.

Baggage & personal effects

Reimbursement for luggage and personal articles, as well as expenses to reissue passports or visas, if your bags are lost, stolen, or damaged.

Baggage delay

Reimbursement for personal articles, such as reasonable additional clothing and toiletries, if your bags are delayed by a common carrier for 12 hours or more.

Emergency medical & dental expenses³

Coverage for emergency medical and dental treatment if a sickness or injury occurs during your trip.

Travel assistance services

Includes a wide range of services available 24/7 before and during your trip, including assistance with emergency medical payments, emergency medical evacuation, prescription replacement, and more.

Emergency medical evacuation & repatriation

Physician-ordered emergency medical evacuation to a suitable hospital, help returning home if medically necessary, and repatriation.

Accidental death & dismemberment

Provides a benefit if the insured suffers a covered injury or death while on a trip. Exclusions may apply. See policy for details.

Cancel for any reason⁵

Optional additional protection for the unexpected — whatever it may be — when you meet purchase and cancellation requirements.

- Upgrade must be purchased within 21 days of the initial trip deposit and at the time of the initial plan purchase.
- Upgrade must be purchased 31 days or more before your departure date.
- The maximum trip cost is \$10,000 per person, and the full trip cost must be insured.
- Subsequent arrangements must be insured within 21 days of booking those arrangements.

Cancellation must occur two days or more before your scheduled departure date.

Pre-existing medical condition exclusion waiver⁹

Pre-existing medical conditions are eligible for coverage when:

- The traveler is medically able to travel at the time of plan purchase.
- The plan is purchased at or before final trip payment.
- Subsequent arrangements must be insured within 21 days of booking those arrangements.

A pre-existing medical condition is a sickness, disease, or other condition of you, a traveling companion, or a family member traveling with you for which they have received a recommendation for, or received a diagnostic test, examination, medical treatment, or prescription for drugs or medicine within the 120-day look-back period (in most states) immediately preceding your plan purchase date.

Plan details

View the description of coverage at Partner.TravelexInsurance.com/docs/StarDestinationsTravelProtection-DOC.

⁹State variations apply. Pre-existing medical condition exclusions do not apply to residents of NH.

Unless otherwise stated in the plan, this plan will not pay for any loss arising directly or indirectly out of, or as a result of, or from, or that occur to, or are as a result of the actions of, the Insured or the Insured's Family Member, or Traveling Companion, or Business Partner for the following: suicide, attempted suicide, or intentionally self-inflicted injury, while sane or insane (while sane in CO and MO); mental, nervous, or psychological disorders; being under the influence of drugs or intoxicants, unless prescribed by a Physician; Normal Pregnancy, resulting childbirth, and elective abortion; participation as a professional in athletics while on a Covered Trip; participation in organized amateur or interscholastic athletic or sports competition or related practice events; riding or driving in any motor competition; off-road driving, whether as a driver or as a passenger; declared or undeclared war, or any act of war; civil disorder; service in the armed forces of any country; nuclear reaction, radiation, or radioactive contamination; operating or learning to operate any aircraft, as pilot or crew; mountain climbing, bungee jumping, snow skiing, skydiving, Parachuting, free falling, cliff diving, BASE or base jumping, hang gliding, parasailing, travel on any air-supported device other than on a regularly scheduled airline or air charter company, or extreme sports; mountaineering where ropes or guides are commonly used, including ascending and descending a mountain requiring specialized equipment that includes but is not limited to anchors, bolts, carabiners, crampons, lead/top-rope anchoring equipment, and pick-axes; scuba diving if the depth of the water exceeds 75 feet; the Insured's commission of or attempt to commit a felony; elective medical or holistic treatment or procedures; failure of any tour operator, Common Carrier, other travel supplier, person, or agency to provide the bargained-for travel arrangements/services; a loss that results from a sickness, disease, or other condition, event, or circumstance that occurs at a time when this Policy is not in effect for the Insured; a diagnosed sickness (if insurance is purchased after such diagnosis) from which no recovery is expected, and that only palliative treatment is provided, and that carries a prognosis of death within 12 months of the effective date of the applicable coverage under this Policy; sickness, injury, or death if the plan is purchased after entering a hospice facility or receiving hospice treatment; any Trip taken outside the advice of a Physician; or a Pre-Existing Condition, including death, that results therefrom (within the stated look-back period within your insurance policy). Additionally, this plan will not pay for any loss arising directly or indirectly out of, or as a result of, or from, or that occur to, or are as a result of the actions of the following that occur to the Insured: any amount paid or payable under any Worker's Compensation, disability benefit, or similar law; a loss or damage caused by detention, confiscation, or destruction by customs; or medical treatment during a Covered Trip, or arising from a Covered Trip, undertaken for the purpose or intent of securing medical treatment. The following additional exclusion applies to Accidental Death and Dismemberment Benefits: We will not pay for loss caused by or resulting from sickness of any kind.

Please refer to your plan documents for a complete list of plan exclusions and limitations, as well as the definitions of capitalized terms used herein.

This plan provides insurance coverage for your trip that applies only during the covered trip. The purchase of this product is not required in order to purchase any other travel product or service. Your travel retailer might not be licensed to sell travel insurance and will only be able to provide general information about the product. An unlicensed travel retailer may not answer questions about the terms and conditions of the insurance offered and may not evaluate the adequacy of your existing insurance coverage. The products being offered provide insurance coverage that only applies during your covered trip. You may have insurance coverage from other sources that provides similar benefits but may be subject to different restrictions, depending on the coverage. You may wish to compare the terms of the travel policy offered through Travelex with any existing life, health, home, and automobile insurance policies you may have. If you have questions about your coverage under your existing insurance policies, contact your insurer or insurance agent or broker.

All terms, conditions, exclusions, and provisions of the policy discussed, reviewed, quoted, or purchased apply. All benefits associated with the policy will be determined by the claims administrator at the time a claim is filed, based on the information and documentation submitted. All information collected by Travelex is subject to its privacy policy at TravelexInsurance.com/Company/Privacy.

Any inquiry regarding claims may be directed to Zurich Travel Claims Administration at Support@ZurichTravelClaims.com; P.O. Box 1019, Youngwood, PA 15697-0919; or +1-800-501-4781. Inquiries regarding new, existing, or denied claims and any other claims questions may also be directed to this address. Consumers in California may also contact the California Department of Insurance Hotline at +1-800-927-4357 or +1-213-897-8921. Travelex Insurance Services, Inc. CA agency license #0DI0209. Consumers in Maryland may contact the Maryland Insurance Administration at +1-800-492-6116 or +1-410-468-2340.

Insurance coverage underwritten by individual member companies of Zurich in North America, including Zurich American Insurance Company (NAIC #16535, state of domicile: New York), 1299 Zurich Way, Schaumburg, IL 60196. Certain coverages not available in all states. The terms and conditions of the policy described in this brief summary are governed by the individual policy document that contains the complete terms. In the event of any discrepancy between the information in this brief summary and the policy, the policy document shall govern. This is intended as a general description of certain types of insurance available to qualified customers, provided solely for informational purposes. Policy Form Series U-TIIV-100-A CW, U-TIIN-100/110-A CW, U-TIGV-100-A CW; U-TIGN-100-A CW; in DC U-TIIV-100-A DC & U-TIGV-100-A DC; in IN U-TIIN-100/110-A IN & U-TIGV-100-A IN; in KS U-TIIN-110-A KS; in MN U-TIIV-100-B MN & U-TIGV 100-B MN; in MO U-TIIN-110-A MO; in MT U-TIIN-100/110 MT & U-TIGN-100-A MT; in NH U-TIIV-100-A NH; U-TIIV-101-B NY, U-TIIN-100 NY; in OR U-TIIV-100-A OR; in VA U-TIIV-100-A VA and U-TIGV-100-A VA; in VT U-TIIN-100/110-A VT and U-TIGN-100-A VT.

1224-STRFLY1_SR_112524_V1

